

Preparation of compressed air ► Pressure gauge

Pressure gauge, Series PG1-SAS

► Front port ► Background color: Black ► Scale color: White / Grey ► Viewing window: Polystyrene ► Units: bar / psi



00123444

Version	Bourdon tube pressure gauge
Standardization	EN 837-1
Main scale unit (outside)	bar
Secondary scale unit (inside)	psi
Ambient temperature min./max.	-40°C / +60°C
Medium	Compressed air
Pointer color	White
Main scale color (outside)	White
Secondary scale color (inside)	Grey
Class	2,5

Materials:	
Housing	Acrylonitrile butadiene styrene
Thread	Brass
Viewing window	Polystyrene
Seal	Polytetrafluorethylene

	Compressed air connection	Nominal diameter	Range of application	Display range	Operating pressure	Scale value	Weight	Note	Part No.
		[mm]	[bar]	[bar]	[bar]		[kg]		
	G 1/8	40	0 - 1.2	0 - 1.6	0 / 1.6	0.05	0.08	-	R412003853
	G 1/8	40	0 - 2	0 - 2.5	0 / 2.5	0.1	0.08	-	R412003854
	G 1/8	40	0 - 3.2	0 - 4	0 / 4	0.1	0.08	-	R412003855
	G 1/8	40	0 - 4	0 - 6	0 / 6	0.2	0.08	-	R412003856
	G 1/8	40	0 - 8	0 - 10	0 / 10	0.2	0.08	-	R412003857
	G 1/8	40	0 - 12	0 - 16	0 / 16	0.5	0.08	-	R412003858
	G 1/4	40	0 - 1.2	0 - 1.6	0 / 1.6	0.05	0.08	-	R412004407
	G 1/4	40	0 - 2	0 - 2.5	0 / 2.5	0.1	0.08	-	R412004408
	G 1/4	40	0 - 3.2	0 - 4	0 / 4	0.1	0.08	-	R412004409
	G 1/4	40	0 - 4	0 - 6	0 / 6	0.2	0.08	-	R412004410
	G 1/4	40	0 - 8	0 - 10	0 / 10	0.2	0.08	-	R412004411
	G 1/4	40	0 - 12	0 - 16	0 / 16	0.5	0.08	-	R412004412
	G 1/4	50	0 - 1.2	0 - 1.6	0 / 1.6	0.05	0.09	-	R412004413
	G 1/4	50	0 - 2	0 - 2.5	0 / 2.5	0.1	0.09	-	R412004414
	G 1/4	50	0 - 3.2	0 - 4	0 / 4	0.1	0.09	-	R412004415
	G 1/4	50	0 - 4	0 - 6	0 / 6	0.2	0.09	-	R412004416
	G 1/4	50	0 - 8	0 - 10	0 / 10	0.2	0.09	1)	R412004417
	G 1/4	50	0 - 12	0 - 16	0 / 16	0.5	0.09	1)	R412004418
	G 1/4	50	0 - 20	0 - 25	0 / 25	1	0.09	-	R412007898
	G 1/4	63	0 - 1.2	0 - 1.6	0 / 1.6	0.05	0.1	-	R412004419
G 1/4	63	0 - 2	0 - 2.5	0 / 2.5	0.1	0.1	-	R412004420	
G 1/4	63	0 - 3.2	0 - 4	0 / 4	0.1	0.1	-	R412004421	
G 1/4	63	0 - 4	0 - 6	0 / 6	0.2	0.1	-	R412004422	
G 1/4	63	0 - 8	0 - 10	0 / 10	0.2	0.1	-	R412004423	
G 1/4	63	0 - 12	0 - 16	0 / 16	0.5	0.1	-	R412004424	

1) Suitable for use in Ex zones 1, 2, 21, 22

Preparation of compressed air ▶ Pressure gauge

Pressure gauge, Series PG1-SAS

▶ Front port ▶ Background color: Black ▶ Scale color: White / Grey ▶ Viewing window: Polystyrene ▶ Units: bar / psi

Dimensions

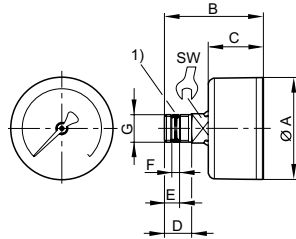

00119457

Compressed air connection G	Nominal diameter	Ø A	B	C	D	E	F 1)	SW				
G 1/8	40	39	44.5	26.5	10	5.6	2.1	14				
G 1/4	40	39	47.5	26.5	13	7.2	3.7	14				
G 1/4	50	49	47.5	26.5	13	7.2	3.7	14				
G 1/4	63	62	47	29	13	7.2	3.7	14				

1) Gasket thread