

TIP:
XM316VS2H20/3



ELECTRIC WIRE ROPE HOIST
XM SERIES

SPARE PARTS
CATALOGUE

MAIN SPARE PARTS LIST
WITH ITEM CODE

Identification Code (*)

Example: **5 / B-1 / 1**
 ↓ ↓ ↓
 PAGE ITEM
 FIGURE



**WIRE ROPE
AND CHAIN**
electric hoists



MISIA

Misia Paranchi srl

Via dei Lavoratori 9/11 - 20092 Cinisello Balsamo (Milano) Italia

Tel. +39 02 61298983 - Fax +39 02 6121769 - www.misia.com - export@misia.com

CONTENTS

Planetary gearbox	5
Hoists' body	6
Rope guide	7
Coupling & intermediate shaft	8
End lifting switch	9
Overload limiter	10
Conical lifting motor	11
Cylindrical lifting motor	14
Hook block two rope falls - S2	16
Hook block four rope falls - S4	17
Monorail trolley standard headroom (Type 3)	18
Monorail trolley low headroom (Type 83)	20
Bi-rail trolley (Type 53)	22
Misia special tools for hoist maintenance	24
End-trucks - Push button boxes	26
Spare parts' order form	27

WARNING!

Any spare parts' requirement must indicate the hoist's S/N.



XM Hoists models 308 / 312 / 316 / 525

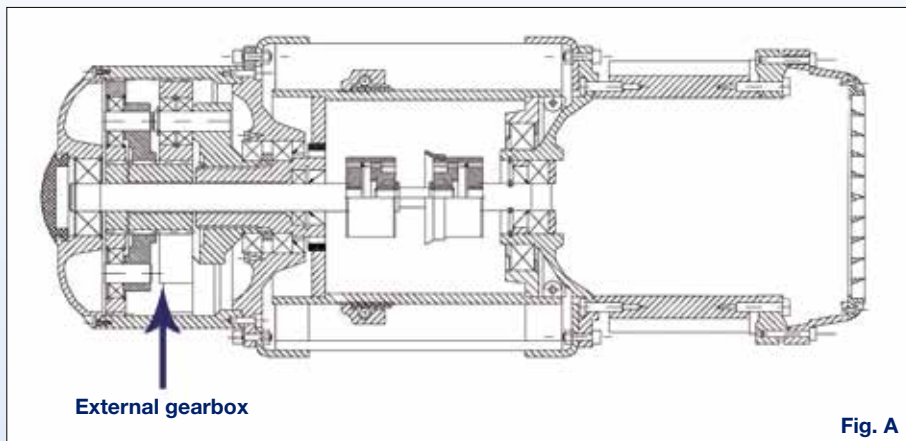

XM Hoists models 740 / 750 / 950 / 963 / 980 / 1100 / 1125

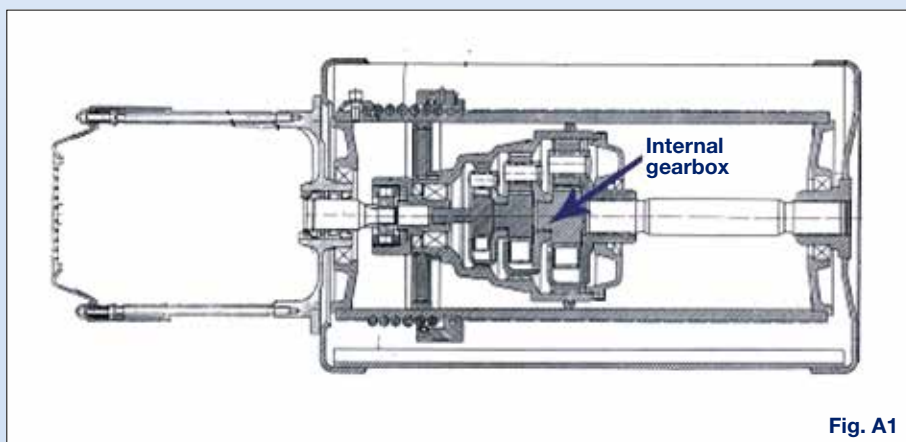

PLANETARY GEARBOX

For XM hoists models 308 / 312 / 316 / 525

- 1 Complete lifting gearbox for hoists models: 308 / 312 / 316 / 525 (its position is on the external side of the hoists' body)
- 2 Gearbox fast shaft
- 3 Fast shaft's seal ring
- 4 Slow shaft's seal ring
- 5 Oil's cork
- 6 Vent valve

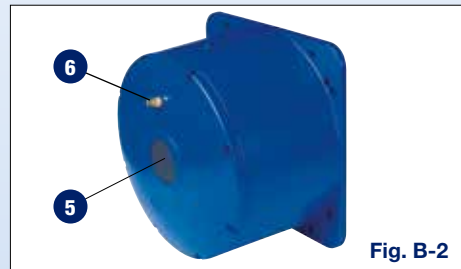
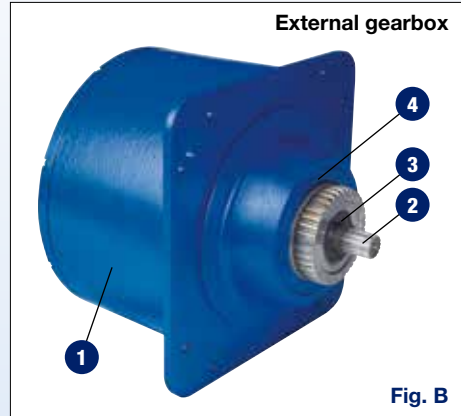

For XM hoists models 740 / 750 / 950 / 963 / 980 / 1100 / 1125

- 1 Complete lifting gearbox for hoists models: 740 / 750 / 950 / 963 / 980 / 1100 / 1125 (its position is inside the hoist's body)
- 3 Geared coupling
- 4 Fast shaft's seal ring
- 5 Slow shaft's seal ring

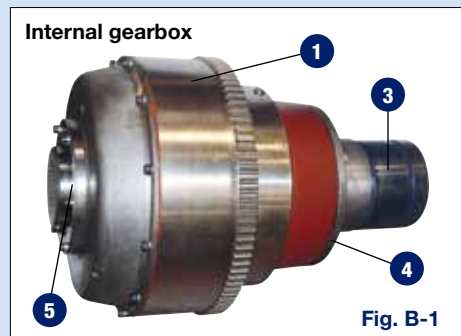

HOIST'S BODY

The body of the hoist is composed by:

- 1 Frame
- 2 Drum
- 3 Fixing rope plate
- 4 Limit switch control bar
- 5 Control bar fixed limiters
- 6 Wire rope
- 7 8 Return sheave with bearing (only 4x rope falls hoists)
- 9 Traverse with compensation pulley

REMARK

For 2x rope falls hoist only consider spares from 1 to 6 (Fig. C).

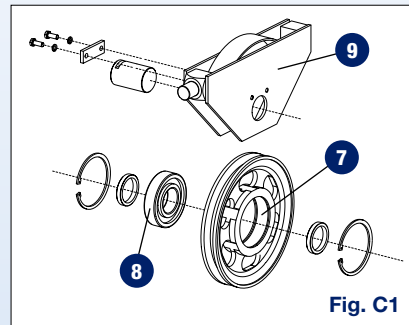

For 4x rope fall hoists pls. refer also to Fig. C1

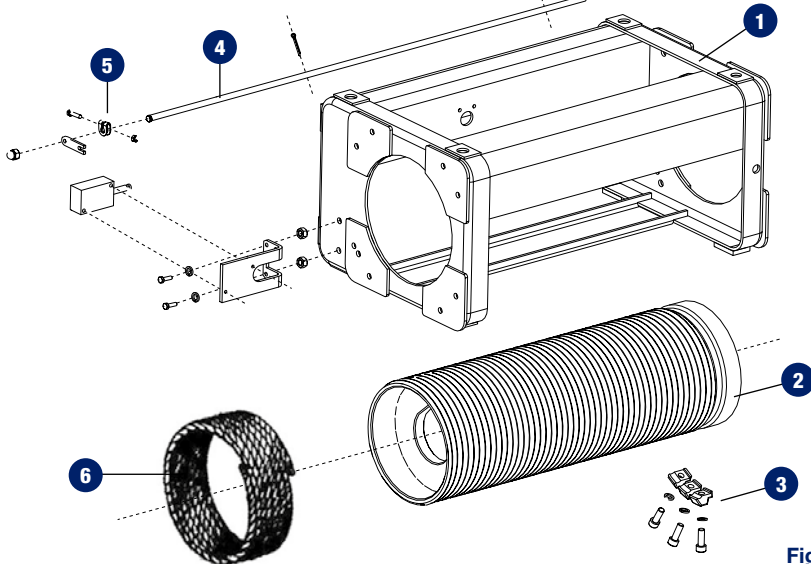

ROPE GUIDE

For XM hoists models 308 / 312 / 316 / 525 / 740 / 750

- 1 Complete rope guide (full set including pad and spring)
- 3 Rope guide spring

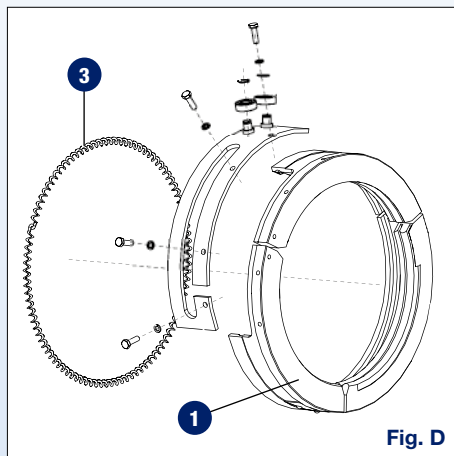

For XM hoists models 950 / 963 / 980 / 1100 / 1125

- 5 Complete rope guide (full set including pad and spring)
- 7 Rope guide spring

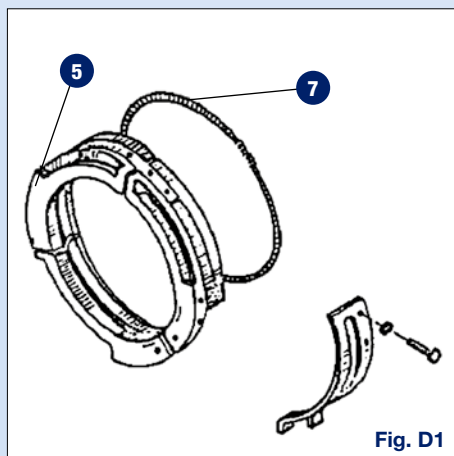

COUPLING & INTERMEDIATE SHAFT

For XM hoists models 308 / 312 / 316 / 525

- 1** Complete set (geared coupling with intermediate shaft)
- 2** Geared coupling (motor side)
- 3** Intermediate connecting shaft
- 4** Geared coupling (gearbox side)

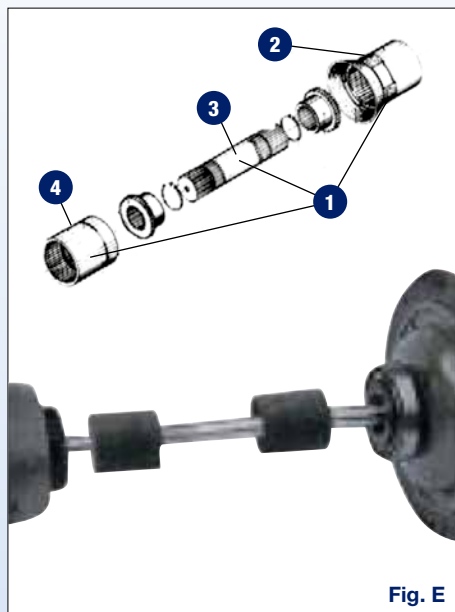

Fig. E

For XM hoists models 740/ 750 / 950 / 963 / 980 / 1100 / 1125

- 5** Complete set of geared couplings
- 6** Geared coupling (gearbox side)
- 7** Geared coupling (motor side)

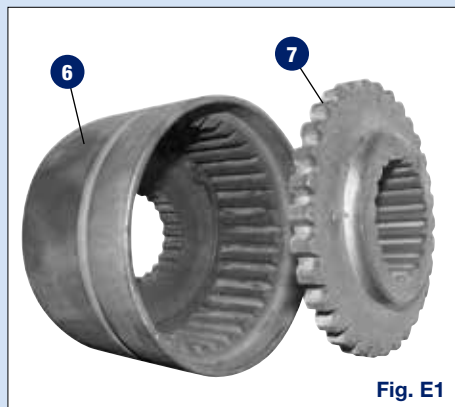
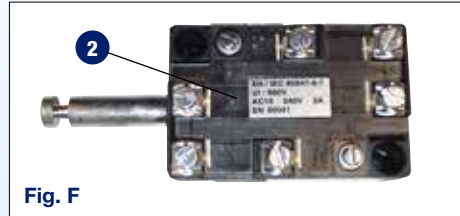

Fig. E1

END LIFTING SWITCH (over-reeving limiter)

For XM hoists models 308 / 312 / 316 / 525 / 740/ 750 / 950 / 963 / 980 / 1100 / 1125

- 1 Complete set end-lifting switch with its cradle box and cable pass-by
- 2 End-lifting switch
- 3 Cradle box with cable pass-by
- 4 Switch fork (connected with limit switch control bar, page 6 / Fig. C / 4)



End lifting switch (external type)



With conical motor:

- 4 Switch fork (connected with limit switch control bar, page 6 / Fig. C / #4)
- 5 End-lifting switch
- 6 Wiring terminal block

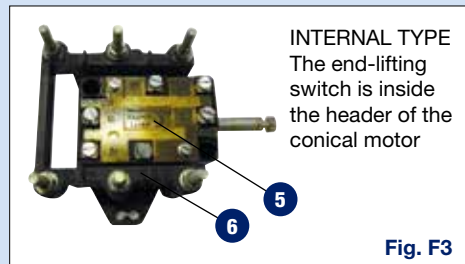

INTERNAL TYPE
The end-lifting switch is inside the header of the conical motor

OVERLOAD LIMITER

Electronic overload limiter with dynamo-metric pin and 24V AC/DC electronic chip

- 1 Dynamo-metric pin
- 2 Box with chip (PCB)
- 3 Setting keypad
- 4 Connector
- 5 Stirrup with wedge for rope fastening

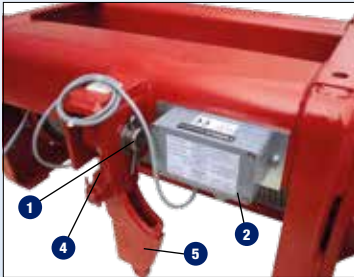

Fig. G



Fig. G1

Electro-mechanical overload limiter with “cup-springs” and micro-switches

- 6 Regulation screw
- 7 Fixing nut
- 8 Micro-switches
- 9 “Cup-springs” set
- 10 Plate

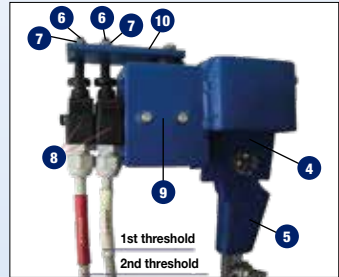

Fig. G2

OVERLOAD LIMITER (Fig. G/ Pos. 2) QUICK-SETTING GUIDE

See DSET 01 and DSET 22 CONNECTIONS

Unless differently requested the OL chip-box Item Fig. G/ Pos. 2) has been pre-set at two different thresholds:

Level 1 = 110% (SWL + 10%)

Level 2 = 125% (SWL + 25%)

During commissioning fine tuning might be needed.

In this case first hang a load whose weight is known ("known load": better if 100% matching the SWL), minimize swinging, and proceed as it follows:

- 1) lift the load and check the correspondence of the intervention levels (Level 1 and Level 2);
- 2) if the intervention levels mismatch:
 - 2a) if the OL intervention OVERTAKES the desired level, turn the trimmer (1 or 2, depending on the level you interfere with) in anti-clockwise direction, so as to reach the desired level;
 - 2b) if the OL intervention ANTICIPATES the desired level, turn the trimmer (1 or 2, depending on the level you interfere with) in clockwise direction, so as to establish the desired level;
- 3) in both cases 2a) or 2b) JUST IGNORE the GREEN LED BLINKING (it only confirms that fine tuning is in progress);
- 4) keep turning until the RED LED (1 or 2, depending on the level you are interfering with) is OFF;
- 5) keep the "SET" button (SET 1 or SET 2, depending on the level you are interfering with) for 5" until the GREEN LED stops blinking;
- 6) drop the load and restart the procedure from point 1), so as to check the new setting.

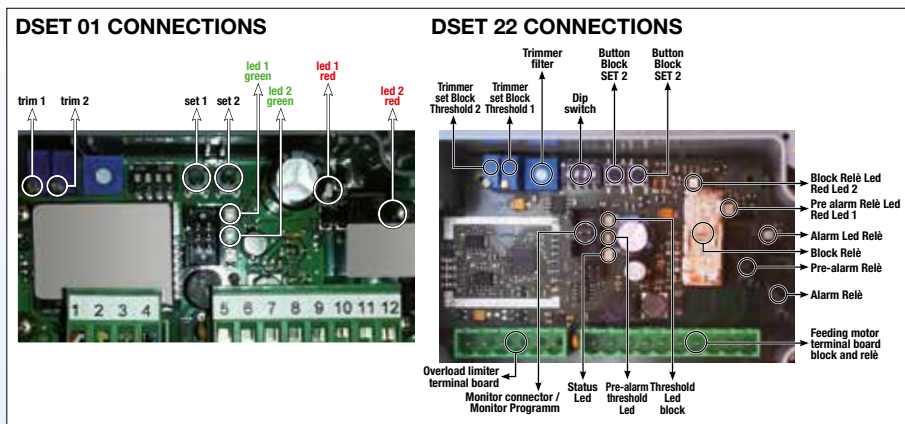

CONICAL LIFTING MOTOR

- 1 Complete lifting motor
- 2 Protection grid
- 3 Brake regulation nut
- 4 Brake fan
- 5 Brake bell
- 6 Motor shaft with rotor
- 7 Stator/Rotor air-gap regulation nut
- 8 Wiring connector terminal block
- 9 Forced-ventilation kit

Fig. H

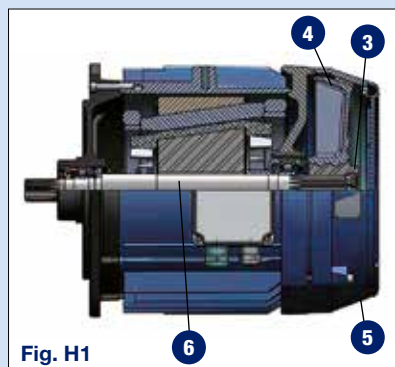
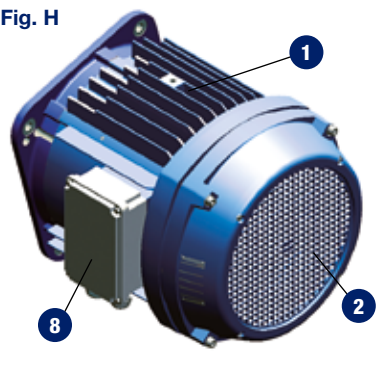

CONICAL LIFTING MOTOR

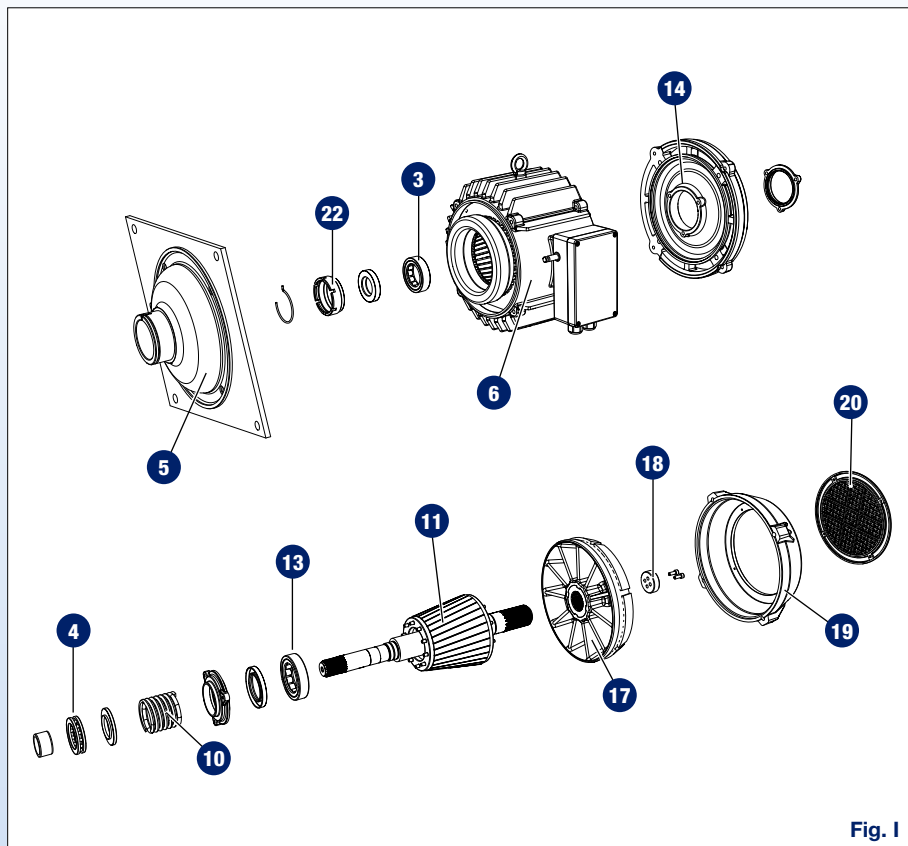

Fig. I

CONICAL LIFTING MOTOR

- 3 Roll bearing
- 4 Axial ball bearing
- 5 Frontal flange
- 6 Stator body
- 10 Spring
- 11 Rotor and shaft
- 13 Roll bearing
- 14 Rear flange
- 17 Brake fan with ferodo
- 18 Brake regulation nut
- 19 Brake bell
- 20 Protection grid
- 22 Nut
- 23 Complete motor

WARNING!

Any spare parts' requirement must indicate the hoist's S/N.

Identification Code (*)

Example: 5 / B-1 / 1
 ↓ ↓ ↓
 PAGE ITEM
 FIGURE



CYLINDRICAL LIFTING MOTOR

- 1 Cooling fan
- 2 Electro-magnet coil
- 3 Motor main body
- 4 Brake disc with ferodo/lining
- 5 Mobile anchor
- 6a 6b Brake current rectifier
- 7 Protection cover
- 9 Complete motor
- 10 (2+4+5) Complete brake

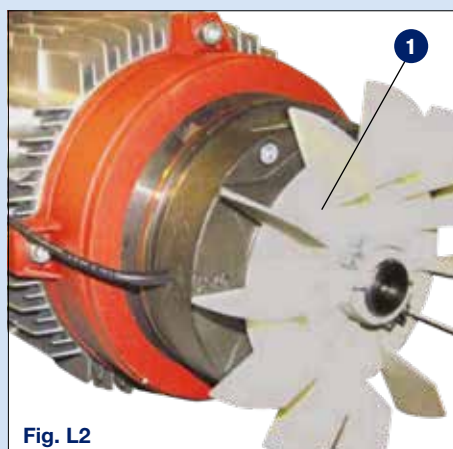
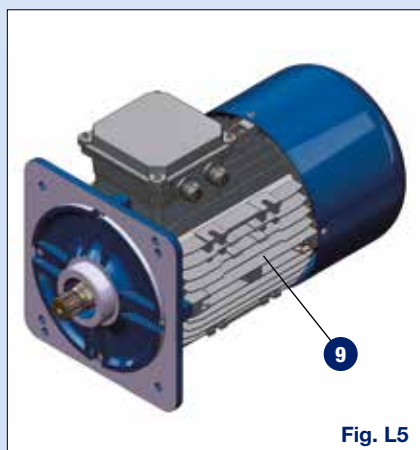
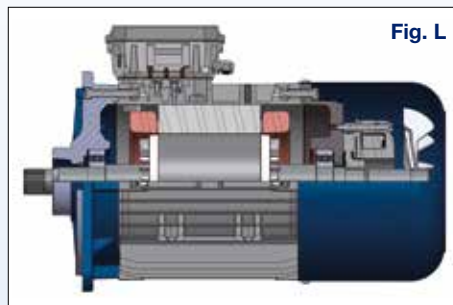

CYLINDRICAL LIFTING MOTOR

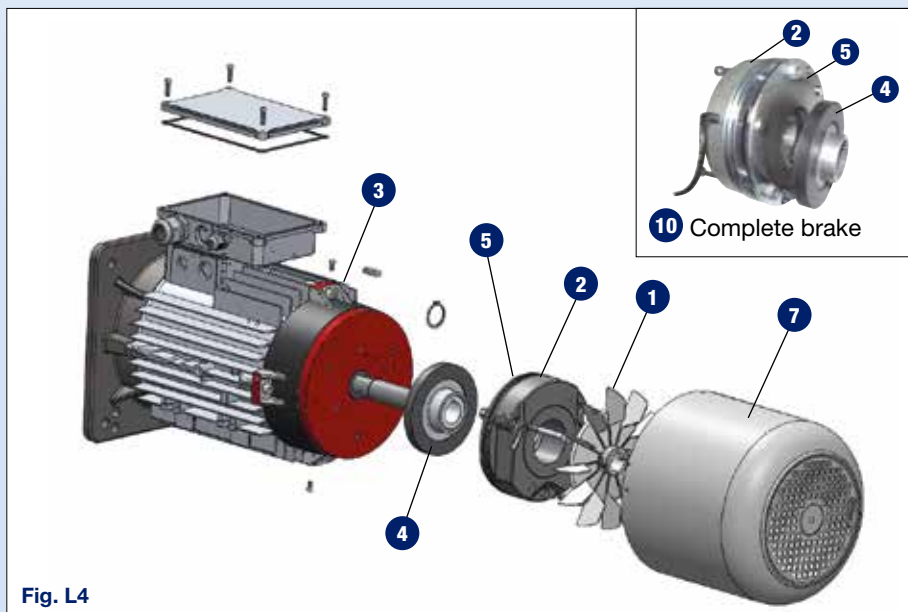
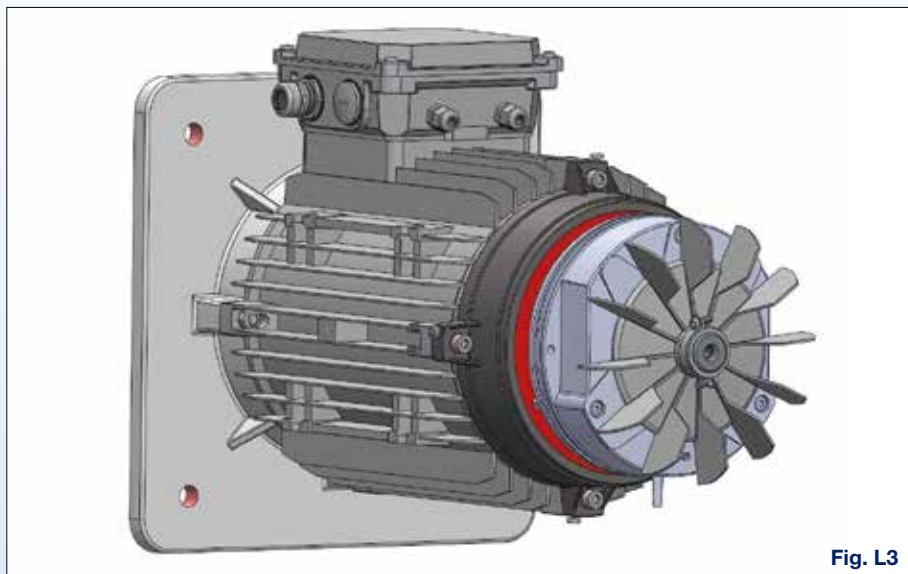

HOOK BLOCK 2X ROPE FALLS - S2 (2/1 REEVINGS)

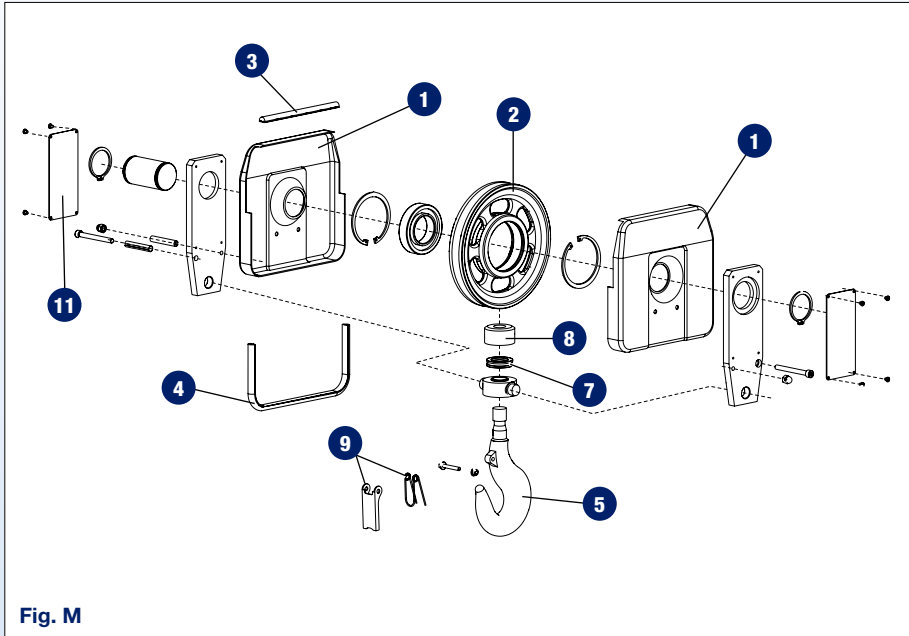

- 1 External cover
- 2 Sheave with bearings
- 3 Upper profile
- 4 Lower profile
- 5 Hook
- 7 Axial bearing
- 8 Nut
- 9 Safety with springs
- 10 Elastic plug
- 11 SWL and Fem class label
- 12 Complete hook block

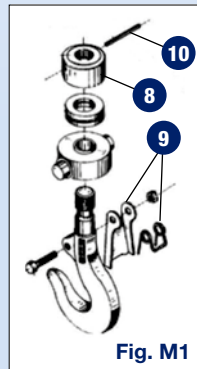

Covers **1** supplied as set with profile **4**.

Hook **5** supplied with nut **8** and axial bearing **7**.

HOOK BLOCK 4X ROPE FALLS - S4 (4/1 REEVINGS)

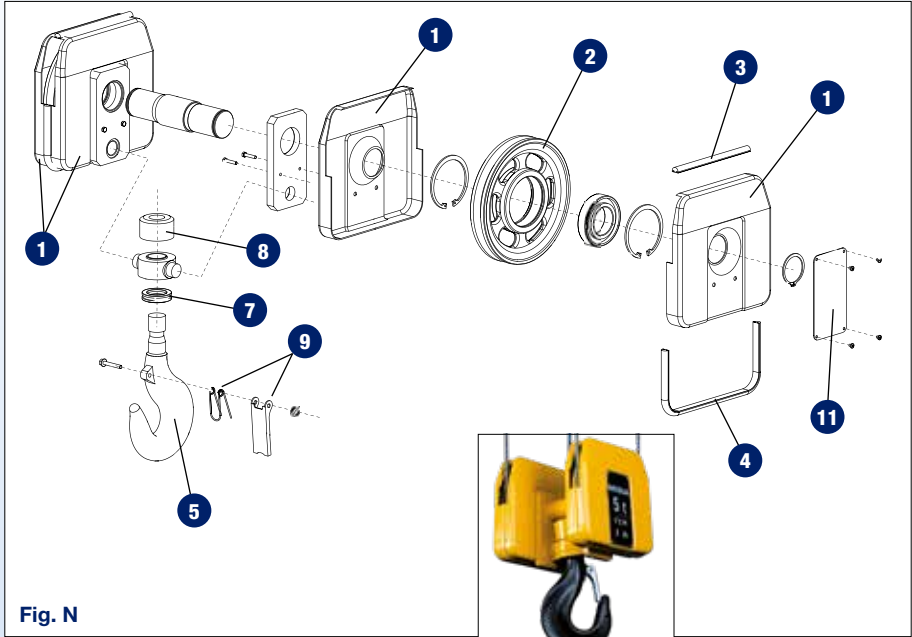

- 1** External case
- 2** Sheave with bearings
- 3** Upper profile
- 4** Lower profile
- 5** Hook
- 7** Axial bearing
- 8** Nut
- 9** Load safety plate with springs
- 10** Plate
- 11** Load capacity and Fem class label
- 12** Elastic plug
- 13** Complete hook block

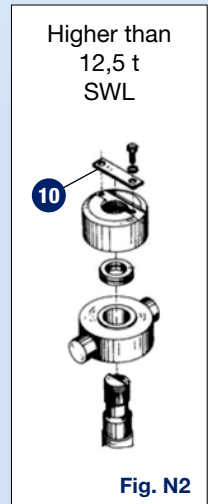
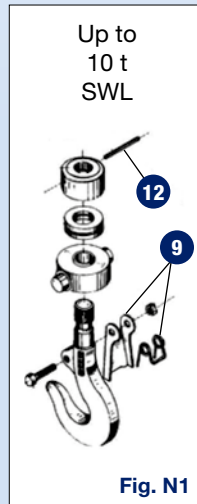

MONORAIL STANDARD TROLLEY (TYPE 3)

- 1 Drive trolley
- 2 Idle trolley
- 3 Travel motor
- 4 Gearbox
- 5 Drive wheel with bearings
- 6 Idle wheel with bearings
- 8 Hoist/Trolley shaft

WARNING!

Any spare parts' requirement must indicate the hoist's S/N.

Identification Code (*)

Example: 5 / B-1 / 1
 ↓ ↓ ↓
 PAGE ITEM
 FIGURE

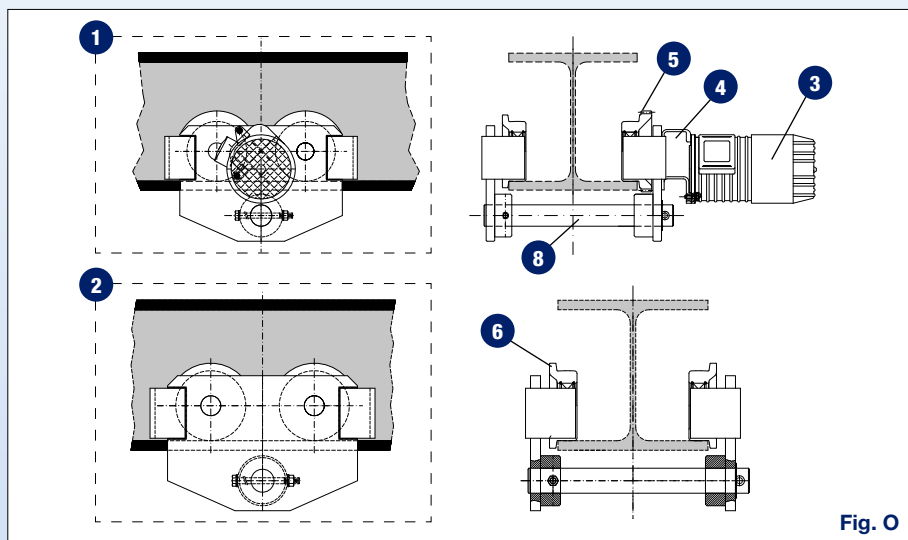

MONORAIL STANDARD HEADROOM (TYPE 3) TRAVEL MOTOR

- 1 Complete travel motor
- 2 Brake current rectifier
- 3 Motor header
- 4 Brake fan with ferodo
- 5 Electro-magnet
- 6 Protection cover
- 7 Mobile anchor
- 8 Brake complete set

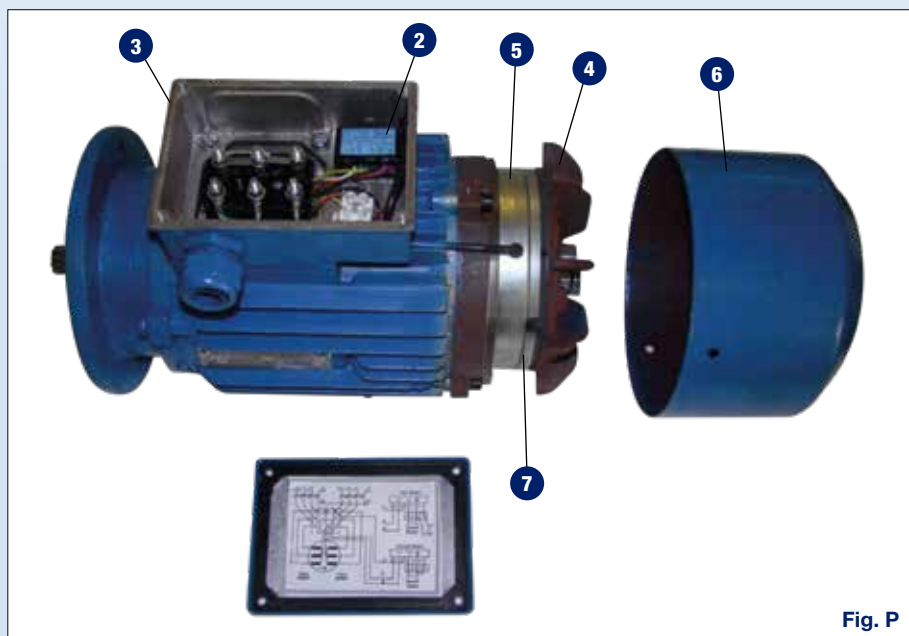
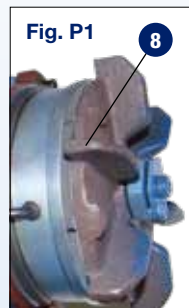

Fig. P

MONORAIL LOW HEADROOM TROLLEY (TYPE 83)

- 1** Travel motor
- 2** Complete gearbox
- 3** Drive wheel with bearings
- 5** Idle wheel with bearings
- 6** Drive wheel control shaft
- 7** Return traverse
(for 4x rope falls hoists only)
- 8** Return sheave with bearings
(for 4x rope falls hoists only)



Fig. Q

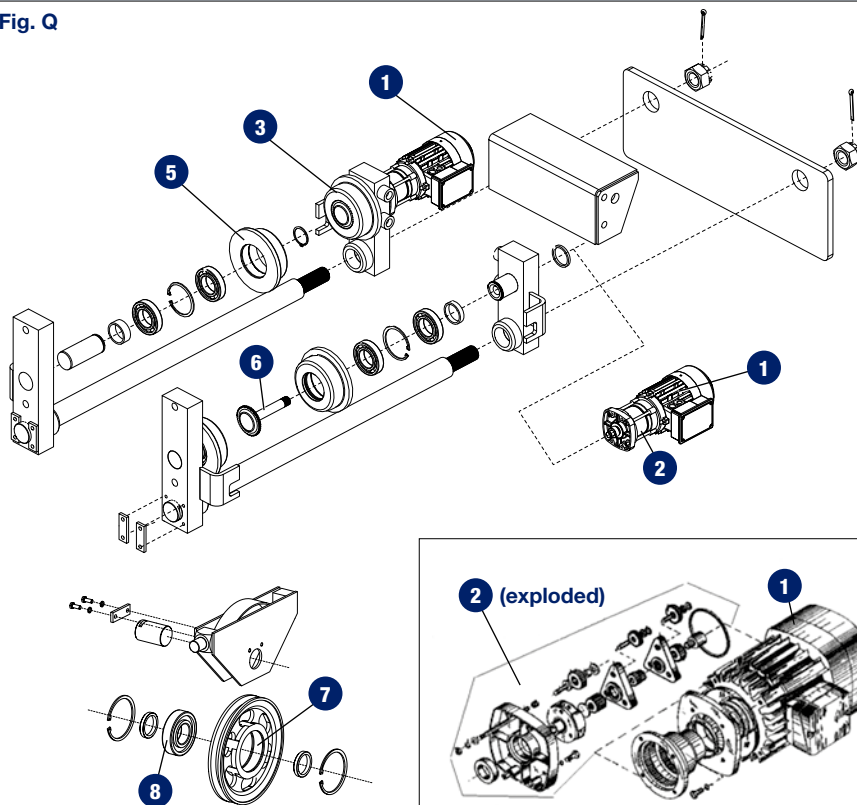
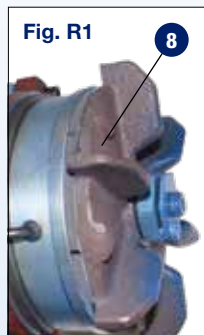

Fig. Q1

MONORAIL TROLLEY LOW HEADROOM (TYPE 83) TRAVEL MOTOR

- 1 Complete travel motor
- 2 Brake current rectifier
- 3 Electro-magnet
- 4 Brake fan with ferodo
- 5 Protection cover
- 6 Motor header
- 7 Mobile anchor
- 8 Brake complete set



BI-RAIL TROLLEY (TYPE 53)

- 1 Travel motor
- 2 Gearbox
- 3 Drive wheel
- 4 Complete bi-rail trolley
- 5 Idle wheel
- 6 Travel motor and its gearbox (complete set)

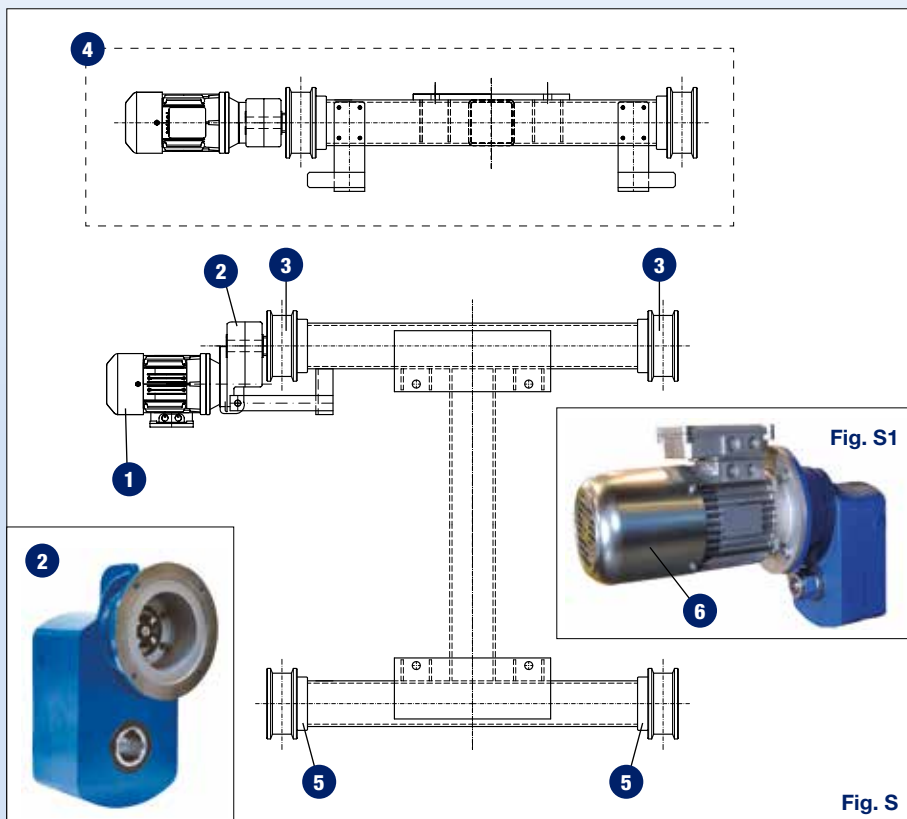

BI-RAIL TROLLEY (TYPE 53) TRAVEL MOTOR

- 6 Complete brake
- 7 Brake current rectifier
- 8 Electro-magnet
- 9 Brake fan with ferodo
- 10 Cover protection
- 11 Motor header
- 12 Mobile anchor

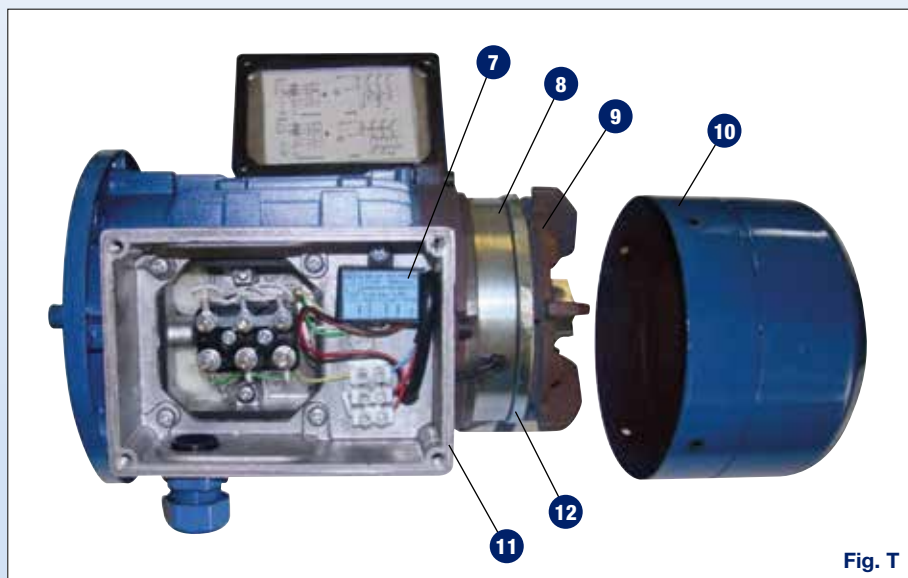
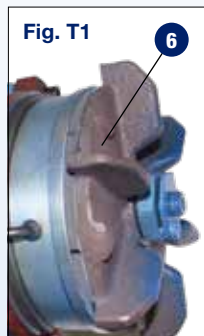

MISIA SPECIAL TOOLS FOR HOIST MAINTENANCE

LX 500 KG

Manual mini hoist for
maintenance



LX 500 KG - CU

Bag





HTFT 01
Ropeguide pliers



HTFT 02
Rope guide spring puller set



HTFT 03
Wheel brake wrench
conical motor



HTFT 04
Wheel brake extractor
conical motor



HTFT 05
Brake fan inserter for
axial insertion



END-TRUCKS - PUSH BUTTON BOXES

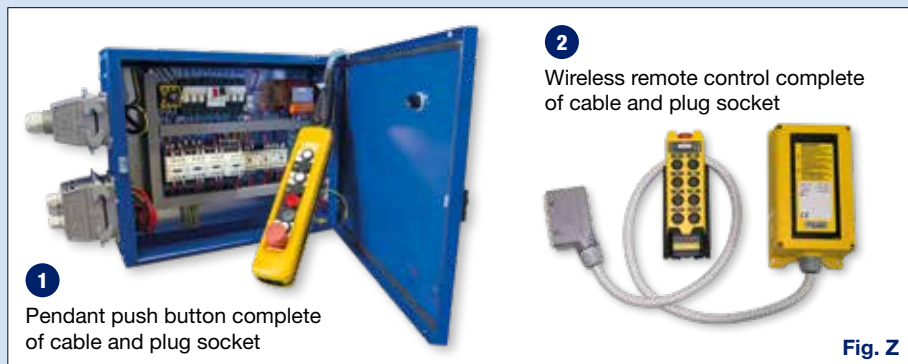
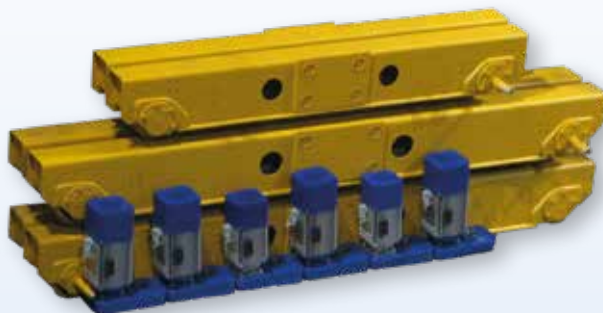

SPARE PARTS' ORDER FORM

 MISIA PARANCHI S.r.l. VIA DEI LAVORATORI, 9/11 20092 CINISELLO B.MO MILANO ITALY			
PARANCO ELETTRICO A FUNE ELECTRIC ROPE HOIST		TIPO TYPE	
N° 94900		TYPE XM312NS4H7A/53a	
PORTATA CAPACITY	5.000 kg.	GRUPPO GROUP	ANNO DI FABBRICAZIONE MANUFACTURING YEAR
CORSA GANCIO HEIGHT OF LIFT	7 m.	FEM 2m	POTENZA POWER
VELOCITA' SOLLEV. HOISTING SPEED	4/1.3 m/min.	ALIMENTAZIONE SUPPLY	4.5/1.5 Kw 415 V. 50 Hz

WARNING!

Any spare parts' requirement must indicate the hoist's S/N.

Identification Code (*)

Example: **5 / B-1 / 1**
 ↓ ↓ ↓
 PAGE ITEM
 FIGURE

Hoist's S/N: _____

Hoist type: _____

Manufacturing year: _____

ITEM (*): _____ / _____ / _____ Units _____

ITEM (*): _____ / _____ / _____ Units _____

ITEM (*): _____ / _____ / _____ Units _____

Remarks: _____



Misia Paranchi srl

Via dei Lavoratori 9/11

20092 Cinisello Balsamo (Milano) Italy

Tel. +39 02 61298983 - Fax +39 02 6121769

www.misia.com - spare@misia.com

09/04/19